

T = Used for Teflon fitted pumps only

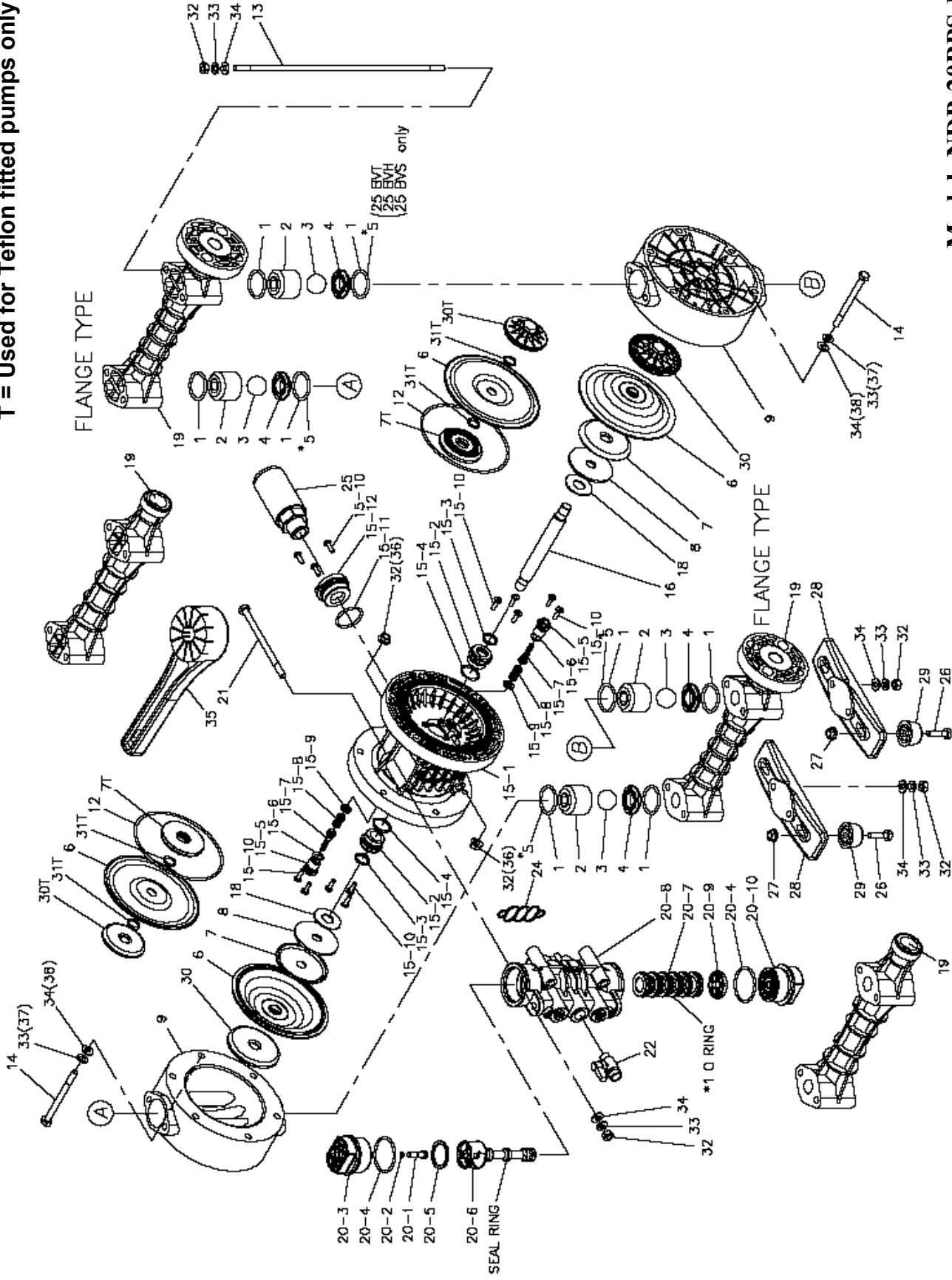

Model: NDP-20BPS-PP
 Part # 854100 - NPT
 Part # 854114 - Flange



Yamada America, Inc.
 955 East Algonquin Rd
 Arlington Heights, IL 60005
 Phone: 847.631.9200
 Fax: 847.631.9273

231M-01_2014

Parts Breakdown

Reference			
No.	Description	Q'ty	Part No.
1	O-ring	8	684116
2	Valve Stopper	4	771216
3	Ball	4	773170
4	Valve Seat	4	780137
6	Diaphragm	2	771973
7	Center Disk	2	716225
7T	N/A	-	-
8	Plain Washer	2	716226
9	Out Chamber	2	780134
12	O-ring	2	640151
13	Tie Rod	4	710122
14	Bolt	12	621166
15	Body Assembly	1	804603
16	Center Rod	1	710252
18	Cushion	2	771054
19	Manifold - NPT	2	780010
19	Manifold - Flange	2	780208
20	Valve Body Assembly	1	804608
21	Bolt	4	686031
22	Ball Valve	1	686018
24	Gasket	1	772848
25	Silencer	1	804697
26	Bolt	4	621151
27	Nut with Flange	16	686032
28	Pump Base	2	771219
29	Cushion	4	770551
30	Center Disk	2	780123
30T	N/A	-	-
31T	N/A	-	-
32	Nut	12	683635
33	Spring Lock Washer	24	681300
34	Plain Washer	24	631329
35	Accessory Tool	2	771244

Repair Kits			
K20-PS-PP Liquid Side Repair Kit			
1	O-ring	8	684116
3	Ball	4	773170
6	Diaphragm	2	771973
12	O-ring	2	640151
K225-AP Air Side Repair Kit			
18	Cushion	2	771054
15-2	Throat Bearing	2	772931
15-3	Packing	2	685414
15-4	O-ring	2	685276
15-5	Valve Seat	2	772932
15-6	O-ring	2	640009
15-7	Pilot Valve Assembly	2	802360
15-8	Spring	2	708666
15-9	Spring Seat	2	772948
15-11	O-ring	1	640132
15-12	Bushing	1	772933
20-2	O-ring	1	640002
20-4	O-ring	2	640043
20-5	Packing	1	771241
20-6 seal	Seal Ring	5	771053
20-7-*1	O-ring	6	686029
20-9	Cushion	1	771914

Body Assembly - 804603			
Reference			
No.	Description	Q'ty	Part No.
15-1	Body	1	772928
15-2	Throat Bearing	2	772931
15-3	Packing	2	685414
15-4	O-ring	2	685276
15-5	Valve Seat	2	772932
15-6	O-ring	2	640009
15-7	Pilot Valve Assembly	2	802360
15-8	Spring	2	708666
15-9	Spring Seat	2	772948
15-10	Tapping Screw	13	686030
15-11	O-ring	1	640132
15-12	Bushing	1	772933

Air Valve Body Assembly - 804608			
Reference			
No.	Description	Q'ty	Part No.
20-1	Rest Button	1	772991
20-2	O-ring	1	640002
20-3	Cap A	1	772946
20-4	O-ring	2	640043
20-5	Packing	1	771241
20-6	C Spool Valve Assy.	1	802400
20-6 seal	Seal Ring	5	771053
20-7	Sleeve Assembly	1	804609
20-7-*1	O-ring	6	686029
20-8	Valve Body Assembly	1	832903
20-9	Cushion	1	771914
20-10	Cap B	1	772947

Yamada America, Inc.
955 East Algonquin Rd
Arlington Heights, IL 60005
Phone: 847.631.9200
Fax: 847.631.9273
www.yamadapump.com